

Instructions

Step 1 - Safety

- Unload the weapon
- Physically and visually inspect the chamber, bore, and magazine well to ensure that all ammunition has been removed.
- Store ammunition in an area that is separate from your training area.

⚠ Always personally verify that all ammunition has been removed before training.

Do not allow any live ammunition in the training area.

WARNING: Failure to follow safety instructions may result in injury or death.

Step 2 - Installation

- 1 - Separate the back and front end of your laser cartridge.
- 2 - Place the adapter, with the threaded end up, on the end of the laser cartridge.
- 3 - Carefully engage the thread. Please note the threading on the adapter is to engage AFTER the adapter is placed on the laser cartridge.
Caution: Do not use force.
- 4 - Insert the battery back into the casing as described in the user guide and attach the cartridges back cap onto the exposed threading.

Full set of video instructions is available at:
www.laser-ammo.com

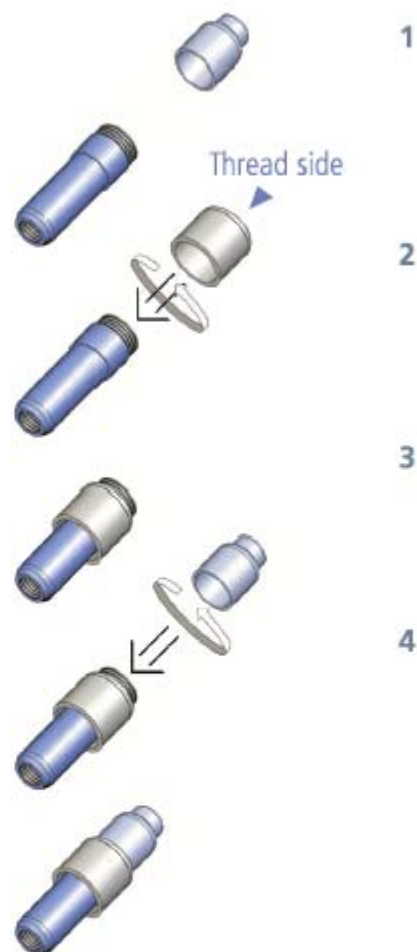

All firearms are potentially dangerous and can cause a great harm, personal injury and death. It is your responsibility and legal obligation to handle, load, unload, use, transport, maintain and store your firearm in a safe manner.

No liability is expressed or implied for damage or injury as a result of installation or use of this product. Warranty is limited to the replacement or repair of the original product only.